

# 6-HORSE STRAIGHT LOAD

## GOOSENECK



The class of the industry! That's what we hear from our customers whenever our Straight Load trailers are the subject of conversation. The center load models, also called 'Head to Head', have floor plans that are extremely versatile. The dividers are moveable and removable. With the addition of alternate settings, the dividers can be moved to form box stalls. Our 'Quiet Ride' option reduces interior noise dramatically and makes relocating the dividers as easy as opening a door. Unlike conventional latches comprised of metal pins and receivers that rattle with every bump, the 'Quiet Ride' component system uses spring loaded tapered cones which lock into a funnel shaped keepers. This design does not allow the components to move relative to each other thereby eliminating noise caused by parts rattling.



- Split Gate Hinged at Side Walls
- 4 Removable Dividers W/Swinging Head Shield Pinned To Removable Post At Each End
- Two-Way Roof Vent Per Horse
- 20 Trailer Ties - Inside
- 12 Trailer Ties - Outside
- Feed Bag Per Horse
- Covered Breast & Butt Bar Each Horse
- 6 Dome Lights
- High Turn Signals
- Halogen Load Light at Each Ramp
- L.E.D. Lighting
- D.O.T. Tape
- Custom Graphics

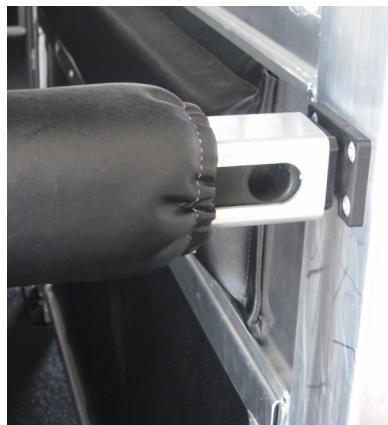

Quiet Ride Breast Bar

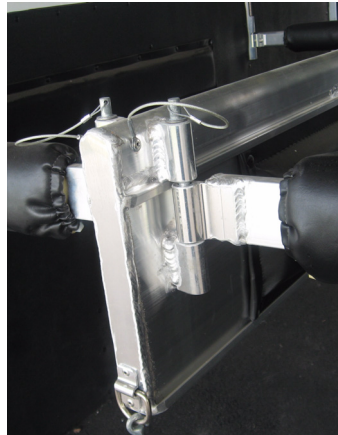

Conventional Breast Bar

### STANDARD FEATURES

- 7'-6" Height x 8'-0"W x 28'-0"L
- 2 - 8000# Torsion 102" Axles - Electric Brakes
- Five 14 Ply Radial Trailer Tires
- 16" Aluminum Wheels
- 2 5/16" Adjustable Coupler
- Single Drop Leg
- Removable Jack Handle
- Tapered Gooseneck w/ 2 Windows
- Polished Cast Corner Caps
- Pre-Painted White Exterior on Smooth Aluminum
- Large Walk-Thru Door w/ Window & Breast Bar SS
- 4 Windows w/ Bars Each Side Horse Compartment
- 50" Wide Side Ramp CS w/ Dutch Door w/ Window & Padded Safety Chain
- Full Width Rear Ramp w/ Dutch Door w/ Window
- Permanent Bulkhead Wall
- Smooth Ribbed Aluminum Floor
- Floor Mats Full Length
- Insulated And Double Walled Full Length And Drop
- Rubber Lined Walls
- Rubber Lined Wheel Wells

### POPULAR OPTIONS

- Quiet Ride Components
- Additional Running Lights
- Air Ride Axles
- Box Stall Settings
- Drop Down Doors
- Electric Hydraulic Brakes
- Larger Window Sizes
- Additional Height
- Lengths Up To 44'
- Widths Up To 8'-6"
- Stainless Steel On Nose
- Stud Doors
- Tapered Fender Wells
- WERM Flooring
- Stow-Away Breast Bar At Side Ramp

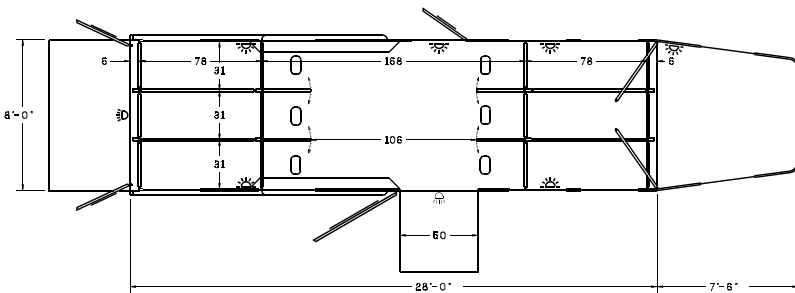

All 4-Star Trailers Come With Our

**8 YEAR WARRANTY**

4-Star Trailers, Inc.

10,000 N.W. 10<sup>th</sup> St. Oklahoma City, Ok 73127

800-848-3095 • www.4startrailers.com

All dimensions are approximate. Photos may show options.

# 6-HORSE STRAIGHT LOAD

## GOOSENECK

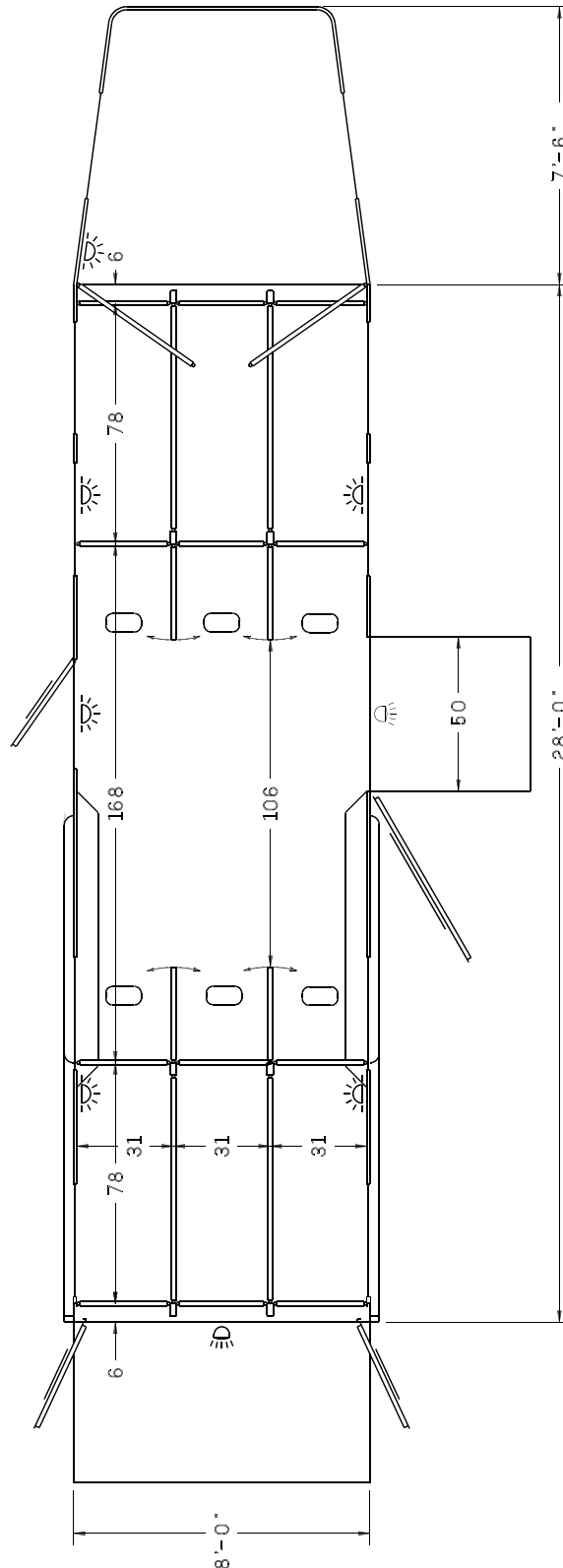

4-Star Trailers, Inc.  
10,000 N.W. 10<sup>th</sup> St. Oklahoma City, Ok 73127  
800-848-3095 • [www.4startrailers.com](http://www.4startrailers.com)  
All dimensions are approximate. Photos may show options.